

4L30E (AR25, AR35)

4 SPEED RWD (Full Electronic Control)

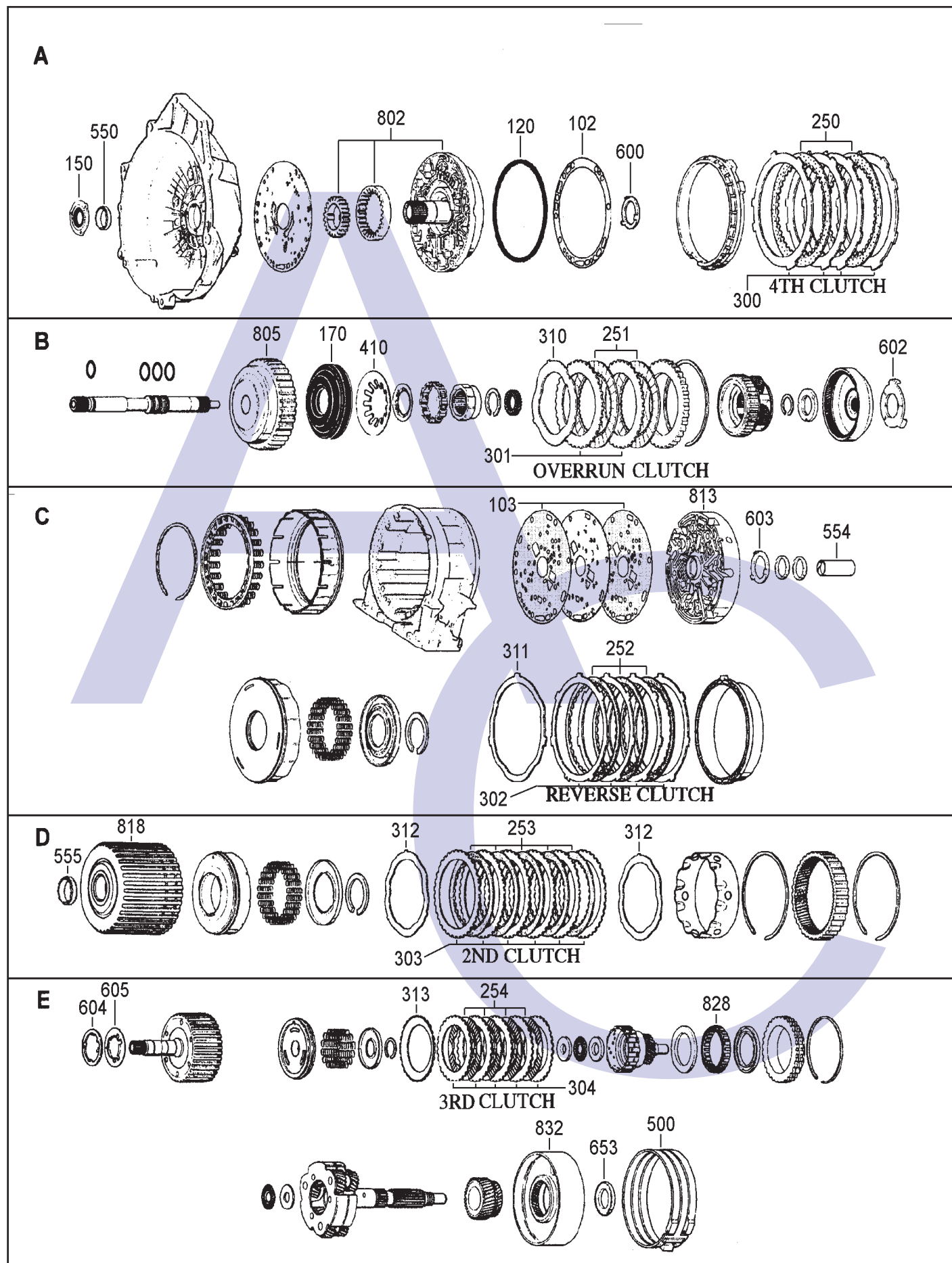

4L30E (AR25, AR35) 4 SPEED RWD (Full Electronic Control)

F

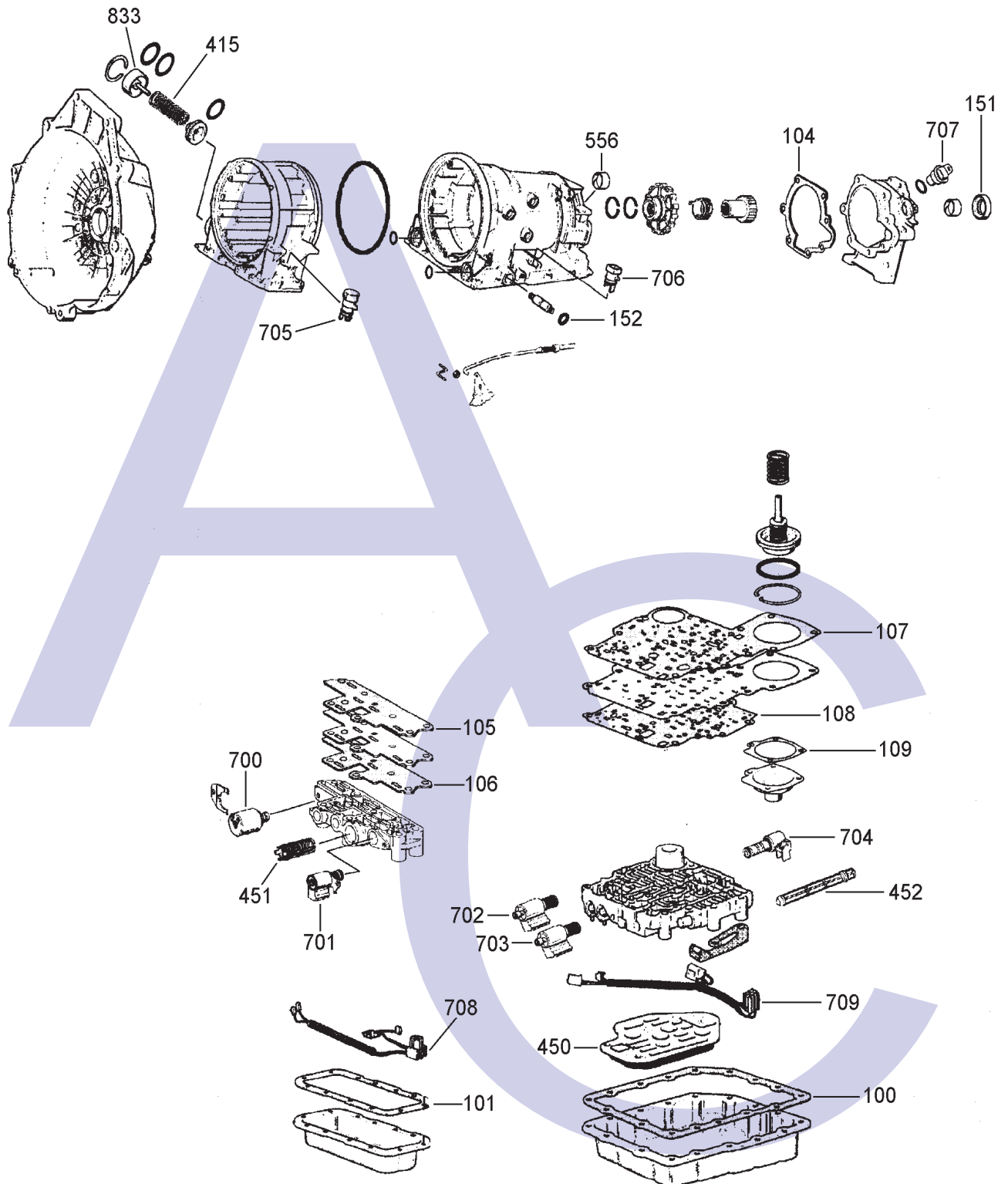

4L30E (AR25, AR35)

4 SPEED RWD (Full Electronic Control)

ILL NO.	DESCRIPTION	YEARS	QTY	PART NO
KITS				
Kit	Overhaul Kit (Transtec).....	90-ON	1	4L30E.OHK01
Kit	Overhaul Kit (Toledo).....	90-ON	1	4L30E.OHK02
Kit	Overhaul Kit GM (Precision).....	90-ON	1	4L30E.OHK51
Kit	Overhaul Kit BMW (Precision).....	89-97	1	4L30E.OHK52
Kit	Gasket & Rubber	90-ON	1	4L30E.GSK01
GASKETS				
100F	Pan Gasket Rear (Ex BMW).....	90-ON	1	4L30E.GAS01
100F	Pan Gasket Rear (BMW).....	90-ON	1	4L30E.GAS08
101F	Pan Gasket Front.....	90-ON	1	4L30E.GAS02
102A	Front Pump Gasket.....	90-ON	1	4L30E.GAS03
103C	Centre Carrier Plate Gasket	90-ON	2	4L30E.GAS09
104F	Extension Housing.....	90-ON	1	4L30E.GAS10
105F	Front V Body Gasket Upper.....	90-ON	1	4L30E.GAS06
106F	Front V Body Gasket Lower.....	90-ON	1	4L30E.GAS07
107F	Main V Body Gasket Upper	90-ON	1	4L30E.GAS05
108F	Main V Body Gasket Lower	90-ON	1	4L30E.GAS04
109F	Servo Cover.....	90-ON	1	TH180.GAS04
RUBBER COMPONENTS				
120A	Pump Lathe Cut Seal.....	90-ON	1	TH180.OR01
125F	O.D to Case Lathe Cut Seal	90-ON	1	TH180.OR01
NI	O/D Brake Outer Lip Seal.....	90-ON	1	4L30E.LIP01
NI	O/D Brake Inner Lip Seal.....	90-ON	1	4L30E.LIP02
NI	Bridge Clutch Outer Lip Seal	90-ON	1	4L30E.LIP03
NI	Bridge Clutch Inner Lip Seal.....	90-ON	1	4L30E.LIP04
NI	Filler Tube Seal Multi Lip	90-ON	1	TH125.LIP03
METAL CLAD SEALS				
150A	Converter	90-ON	1	4L30E.MCS01
151F	Extension Housing.....	90-ON	1	4L30E.MCS02
152F	Manual Lever Shaft.....	90-ON	1	4L30E.MCS04
NI	Speedometer Seal.....	90-ON	1	4L30E.MCS03
MOULDED PISTONS				
170B	Overrun Piston Bonded Seals	90-ON	1	4L30E.PIS01
SEALING RINGS				
Kit	Sealing Ring Kit	90-ON	1	4L30E.SRK01
FRICTION PLATES				
Kit	Friction Plate.....	90-ON	1	4L30E.FRK01
Kit	Friction Plate (Alto)	90-97	1	4L30E.FRK51
Kit	Friction Plate (Alto)	98-ON	1	4L30E.FRK52
250A	Overdrive/4th Brake (170mm OD x 2.25mm x 36T) ..	90-ON	3	4L30E.FRP01
251B	Overrun Clutch (129mm OD x 2.25mm x 40T) ..	90-ON	2	4L30E.FRP02
252C	Reverse Brake (163mm OD x 2.50mm x 36T) ..	90-ON	5	TH180.FRP03
253D	Intermediate/2nd Clutch (133mm OD x 2.50mm x 30T) ..	90-ON	5-6	TH180.FRP02
254E	Direct/3rd Clutch (98mm OD x 2.50mm x 12T)	90-97	4	TH180.FRP01
254E	Direct/3rd Clutch (Grooved) (98mm OD x 1.50mm x 12T)	98-ON	5-6	4L30E.FRP03

ILL NO.	DESCRIPTION	YEARS	QTY	PART NO
STEEL PLATES				
Kit	Steel Plate	90-ON	1	4L30E.STK01
Kit	Steel Plate (Alto).....	90-ON	1	4L30E.STK51
300A	Overdrive/4th Brake (148mm ID x 2.11mm x 7T)	90-ON	4	4L30E.STP02
301B	Overrun Clutch (100mm ID x 2.11mm x 36T)	90-ON	2	4L30E.STP01
302C	Reverse Brake (144mm ID x 1.78mm x 7T)	90-ON	AR	TH180.STP03
302C	Reverse Brake (144mm ID x 2.11mm x 7T)	90-ON	5-6	TH180.STP06
303D	Intermediate/2nd Clutch (109mm ID x 1.78mm x 36T)	90-ON	AR	TH180.STP02
303D	Intermediate/2nd Clutch (109mm ID x 2.11mm x 36T)	90-ON	5-7	TH180.STP05
304E	Direct/3rd Clutch (72mm ID x 1.78mm x 30T)	90-ON	AR	TH180.STP01
304E	Direct/3rd Clutch (72mm ID x 2.11mm x 30T)	90-ON	5-6	TH180.STP04
310B	Waved Steel-Overrun Clutch	90-ON	1	4L30E.STP04
311C	Waved Steel-Reverse Brake.....	90-ON	1	4L30E.STP06
312D	Waved Steel-Int/2nd Clutch	90-ON	1	4L30E.STP03
313E	Waved Steel-Direct/3rd Clutch..	90-ON	1	4L30E.STP05
SPRINGS & CIRCLIPS				
410B	Diaphragm Spring (Overrun Clutch)	90-ON	1	4L30E.DIA01
415F	O.D.Accumulator Spring.....	90-ON	1	4L30E.SPR01
FILTERS				
Kit	Filter Kit (Vauxhall).....	90-ON	1	4L30E.FILKIT01
Kit	Filter Kit-Pressure Regulator & Band Control Solenoid	90-ON	1	4L30E.FIL02
450F	Filter 17mm Spout (Vauxhall Ex Monterey).....	90-ON	1	4L30E.FIL01
450F	Filter 11mm Spout (BMW, Trooper, Frontera)	91-ON	1	4L30E.FIL03
451F	Press Control Solenoid Filter.....	90-ON	1	4L30E.FIL04
452F	Band Control Solenoid Filter.....	90-ON	1	4L30E.FIL05
BANDS				
500E	Low Brake (New not Reline)	90-ON	1	TH180.BAN01
BUSHES				
Kit	Bush Kit	90-ON	1	4L30E.BK01
550A	Converter Housing (14.10mm Wide)	90-ON	1	4L30E.BUS01
550A	Converter Housing (Sonnax) (14.10mm Wide)	90-ON	1	4L30E.BUS02
554C	Centre Support	90-ON	1	4L30E.BUS03
555D	Second Clutch Drum.....	90-ON	1	TH180.BUS05
556F	Case	90-ON	1	TH180.BUS09
NI	Low Servo Pin Bore Repair Bush (Use With TOOL.114)	90-ON	1	4L30E.BUS04

4L30E (AR25, AR35)

4 SPEED RWD (Full Electronic Control)

ILL	NO.	DESCRIPTION	YEARS	QTY	PART NO
THRUST WASHERS & BEARINGS					
600A		Pump Selective Thrust With 3 Tabs			
		(1.75mm "Red")	90-ON	AR	TH180.THW01
		(1.96mm "Black")	90-ON	AR	TH180.THW02
		(2.13mm "White")	90-ON	AR	TH180.THW03
		(2.34mm "Green")	90-ON	AR	TH180.THW04
		(2.54mm "Blue")	90-ON	AR	TH180.THW06
602B		Thrust Washer (2 Tabs)			
		Overdrive Ring Gear	90-ON	1	4L30E.THW07
603C		Centre Support Selective Thrust No Tabs			
		(2.00mm "Black")	90-ON	AR	4L30E.THW01
		(2.15mm "White")	90-ON	AR	4L30E.THW02
		(2.30mm "Green")	90-ON	AR	4L30E.THW03
		(2.50mm "Blue")	90-ON	AR	4L30E.THW04
604E		Thrust Washer 2nd-3rd Drum			
		(5 Tang)	90-ON	1	4L30E.THW05
605E		Thrust Plate 2nd-3rd Drum			
		(Steel)	90-ON	1	4L30E.THW06
653E		Thrust Bearing			
		(Low Band Drum to Case)	90-ON	1	4L30E.TOR01
ELECTRICAL COMPONENTS					
700F		Pressure Control Solenoid			
		(Pattern)	90-ON	1	4L30E.SOL01
700F		Press Control Soenoid			
		(Omega/Monterey OEM)	94-ON	1	4L30E.SOL02
700F		Pressure Control Solenoid			
		(Senator OEM)	90-ON	1	4L30E.SOL03
701F		Lock Up Solenoid	90-ON	1	4L30E.SOL04
702F		1-2/3-4 Shift Solenoid	90-ON	1	4L30E.SOL08
703F		2-3 Shift Solenoid	90-ON	1	4L30E.SOL06
704F		Band Control Solenoid	90-ON	1	4L30E.SOL05
705F		Connector Intermediate/Front Case			
		(4 Pin Square)	90-ON	1	4L30E.ELE01
706F		Connector Main/Rear Case			
		(5 Pin Round)	90-94	1	4L30E.ELE02
706F		Connector Main/Rear Case			
		(7 Pin Round)	94-ON	1	4L30E.ELE04
707F		Output Speed Sensor	90-ON	1	4L30E.ELE05
708F		Valve Body Harness (Front)	90-94	1	4L30E.ELE09
708F		Valve Body Harness (Front)			
		(2.0Ltr, 2.5TD & 3.0Ltr Only)	94-ON	1	4L30E.ELE11
708F		Valve Body Harness (Front)			
		(2.2Ltr, 2.6Ltr & 3.2Ltr Only)	94-ON	1	4L30E.ELE12
709F		Valve Body Harness (Rear)	90-94	1	4L30E.ELE08
709F		Valve Body Harness (Rear)			
		(Includes Temp Sensor)	94-ON	1	4L30E.ELE10
VALVE BODY PARTS					
NI		Small Ratio Boost Valve &			
		Sleeve Kit (Sonnax)	90-ON	1	4L30E.VA02
NI		Medium Ratio Boost Valve &			
		Sleeve Kit (Sonnax)	90-ON	1	4L30E.VA03
NI		Large Ratio Boost Valve &			
		Sleeve Kit (Sonnax)	90-ON	1	4L30E.VA01

ILL	NO.	DESCRIPTION	YEARS	QTY	PART NO
HARD PARTS					
802A		Pump Stator & Gears			
		(13.08mm OD Press Reg)	90-ON	1	4L30E.PUM01
805B		Drum, Overrun Clutch	90-ON	1	4L30E.DRU04
813C		Center Support, No Valves			
		(Casting No. 069 DD2)	90-ON	1	4L30E.SUP01
813C		Center Support, With 2 Valves			
		(Casting No. 513 FU2)	90-ON	1	4L30E.SUP02
818D		Drum, Intermediate/2nd	90-ON	1	4L30E.DRU02
828E		Sprag, 3rd Clutch			
		(26 Elements)	90-ON	1	TH180.OWC01
832E		Drum, Low Band	90-ON	1	4L30E.DRU03
833F		Cover, O.D. Accumulator	90-ON	1	4L30E.COV01
NI		Oil Level Plug (In Oil Pan)	94-ON	1	4L30E.LP01
SPECIAL ITEMS					
TOOLS & MANUALS					
NI		ATSG Rebuild Manual	90-ON	1	4L30E.MAN01
NI		Outer Piston Seal Installer,			
		(Overrun Clutch)	90-ON		4L30E.TOOL
NI		Inner Piston Seal Installer,			
		(Overrun Clutch)	90-ON		4L30E.TOOL03
NI		Outer Piston Seal Installer			
		O.D. Brake (171.45mm Dia)	90-ON		4L30E.TOOL01
NI		Inner Piston Seal Insaller			
		(O.D. Brake)	90-ON		4L30E.TOOL05
NI		2nd Clutch Piston Seal Installer	90-ON		4L30E.TOOL04
NI		Pump Remover	90-ON		4L30E.TOOL02
NI		Low Servo Pin Bore Master Repair Kit			
		For 4L30E.BUS04	90-ON		TOOL.114
NI		Low Servo Pin Bore Repair Sub Kit			
		For 4L30E.BUS04	90-ON		TOOL.115